

SECTION A-A

LAMIERA ELETTROZINCATA (EN10152)
VERNICIATO BIANCO RAL 9003 (ESTERNO)
MATERIAL: ZINC COATED STEEL (EN10152)
WHITE RAL 9003 PAINTED

ALLUMINIO
ALUMINIUM

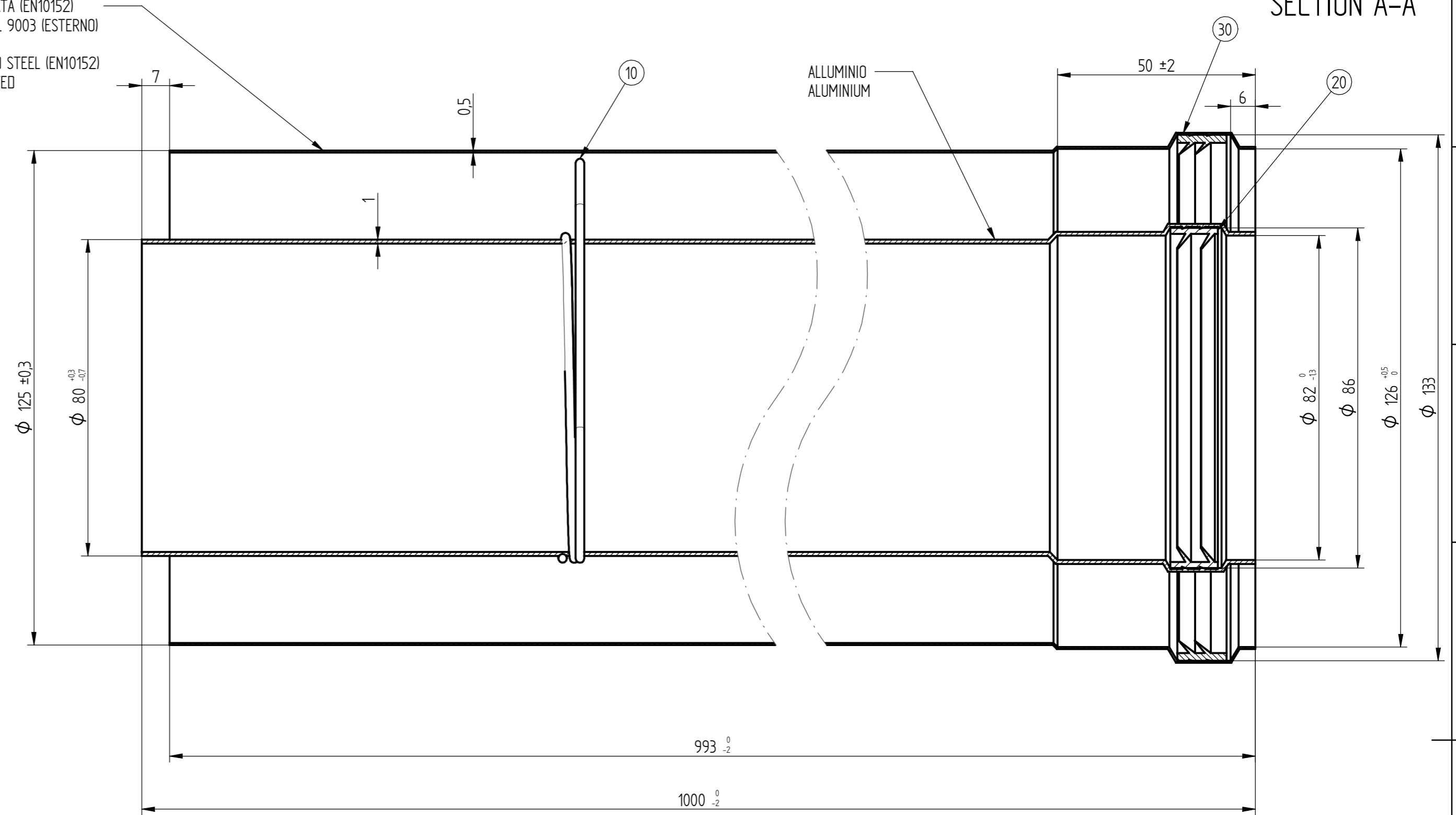
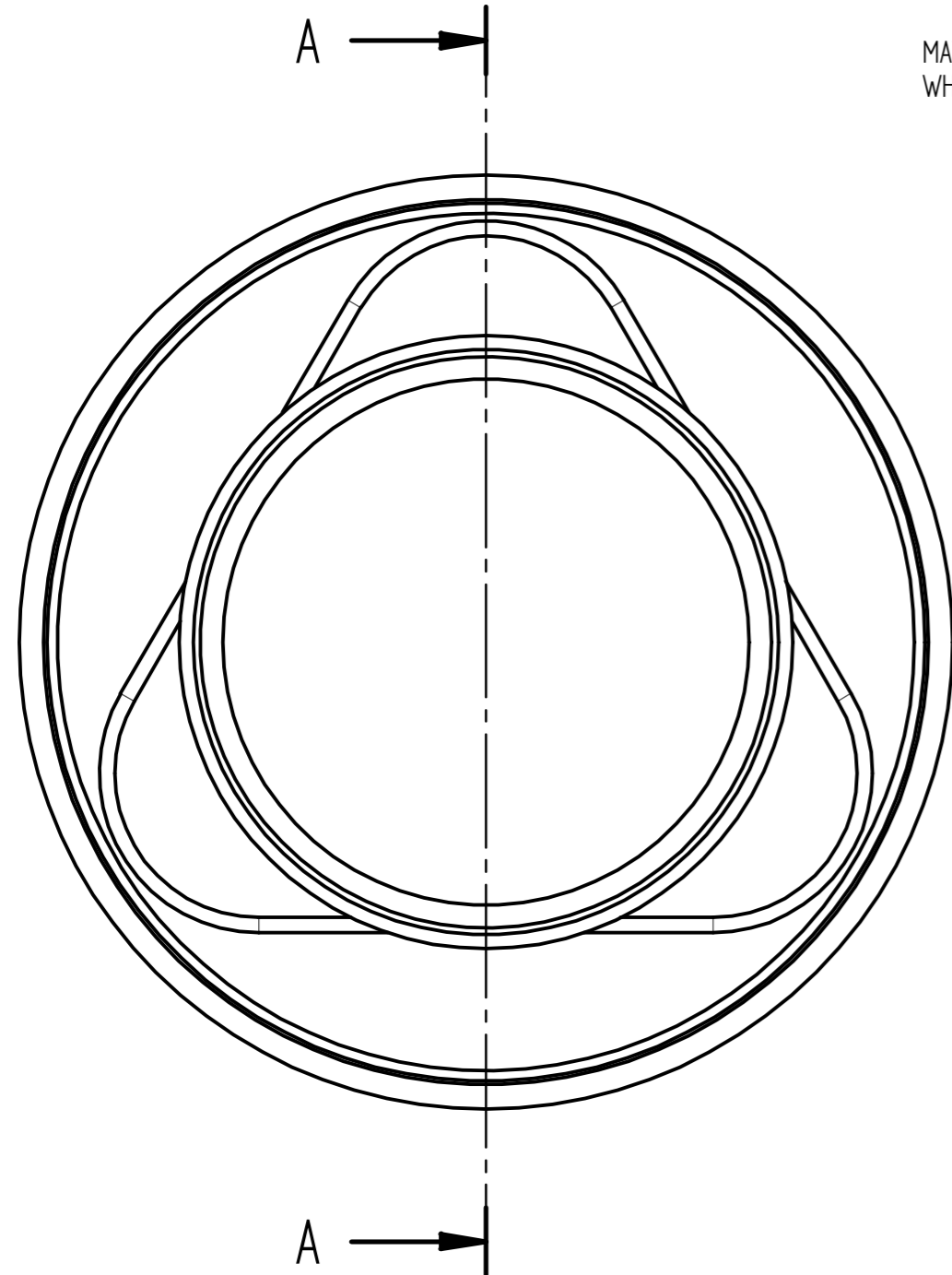

BAXI PRODUCT CODE: KHG714140410

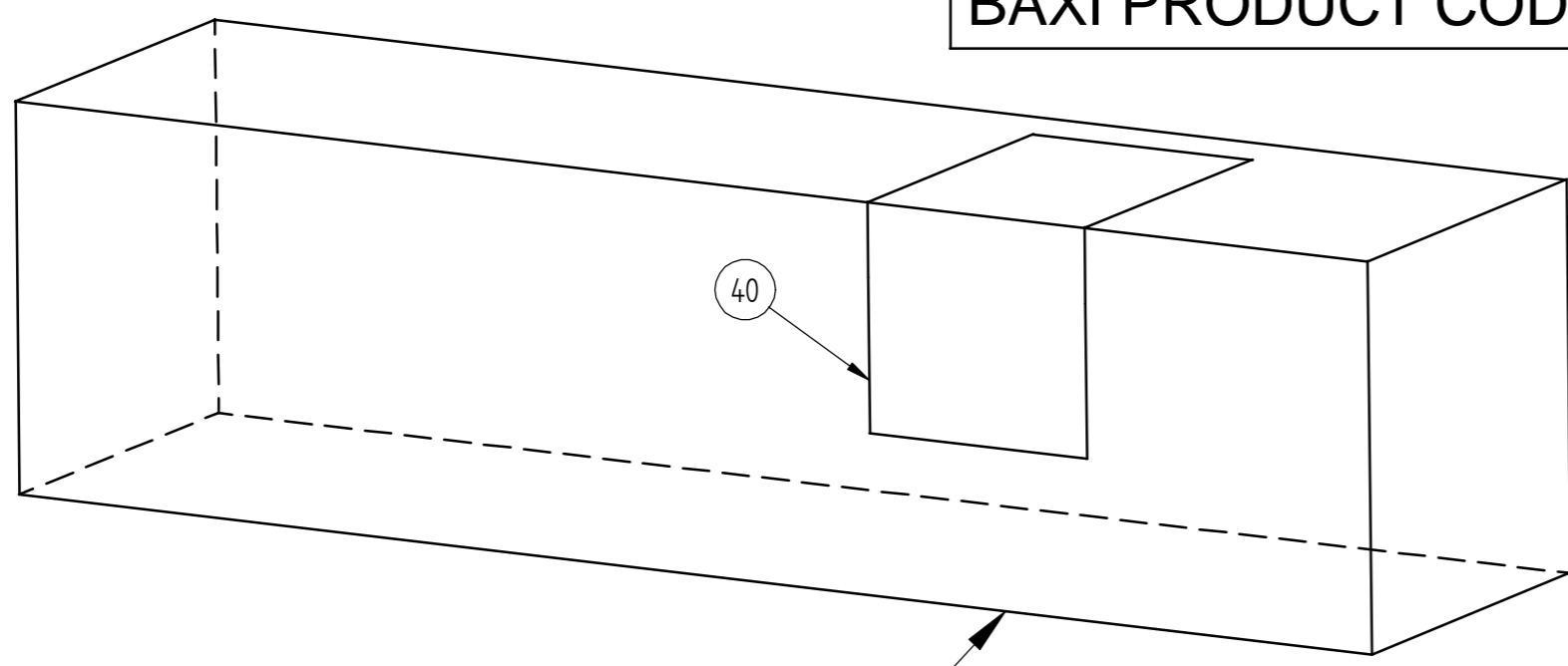

SCATOLA CARTONE 1030x140x140
CARTON BOX 1030x140x140

NOTA: DISEGNO SCATOLA NON IN SCALA
NOTE: THE DRAWING OF THE BOX IS ONLY INDICATIVE

NOTA:
IL PRODOTTO DEVE ESSERE FORNITO IN UNA SCATOLA DI CARTONE IN CUI DEVONO ESSERE PRESENTI LE ETICHETTE IMBALLO, COME MOSTRATO NELLA FIGURA.
NOTE:
THE ITEM MUST BE SUPPLIED IN THE CARTON BOX, IN WHICH MUST BE GLUE ON THE PACK. LABELS, AS SHOWN IN THE DRAWING.

40	7106388	LABEL KIT KHG714140410	1
30	7106345	GASKET D125 EPDM	1
20	7106344	GASKET D80	1
10	7106341	CENTERING SPRING 80/125	1
ITEM NO	PART NUMBER	DESCRIPTION	QTY

REVISION	MODIFICATION	ENGINEER	REFERS TO	DATE
BAXI S.p.A.		RELEASE STATUS: Production	ITEM NUMBER: 7106346.01	REVISION:
A MEMBER OF BAXI GROUP		ENGINEER: CHIURATO P.	DATE: 02-Feb-11	SHEET No. 1 of 1

© 2009	TITLE: KIT FLUE SE 80/125 L1000	MATERIAL SPECIFICATION:	QUALITY SIGNIFICANCE: [C]=CRITICAL [I]=IMPORTANT
UNITS: mm	SCALE: 1:1	TOLERANCE TO EN 22768 - mK UNLESS OTHERWISE SPECIFIED	ITEM CATEGORY (1, 2 OR 3) 3
FIRST ANGLE PROJECTION			A2