



LUNA 3 COMFORT MAX



LUNA 3 COMFORT AIR

## SPARE PARTS CATALOGUE

- January 2015 -



## HOW TO READ THE SPARE PARTS CATALOGUE

In the spare part catalogue, after the exploded diagrams, there are the components lists of the boilers; this is the meaning of the different columns:

Pos.	Identification number of the component in the exploded diagram of the boiler.
Description	Short description of the component.
Code	BAXI S.p.A. code of the component.
Tab. XX	XX is the exploded diagram number of the boiler taken into consideration.

### Until 31th December 2011

From serial number	Date (year and week) identifying the beginning of production of a component (taken from the serial number of the boiler). e.g. B005: year 2000 (B identifies the decade 2000-2009; 0 identifies the year) – 5th week. If the box is empty, the component is in use from the beginning of production of the boiler.
To serial number	Date (year and week) identifying the end of production of a component (taken from the serial number of the boiler). e.g. B012: year 2000 (B identifies the decade 2000-2009; 0 identifies the year) – 12th week. If the box is empty, the component is still in use.
Interchangeable	It identifies the interchangeability between the new component and the old one. YES: components are interchangeable. NO: components are not interchangeable.

### From 1st January 2012

From serial number	Date (year and week) identifying the beginning of production of a component (taken from the serial number of the boiler). e.g. 1201: year 2012 (1 identifies the decade 2010-2019; 2 identifies the year) – 01th week. If the box is empty, the component is in use from the beginning of production of the boiler.
To serial number	Date (year and week) identifying the end of production of a component (taken from the serial number of the boiler). e.g. 1225: year 2012 (1 identifies the decade 2010-2019; 2 identifies the year) – 25th week. If the box is empty, the component is still in use.
Interchangeable	It identifies the interchangeability between the new component and the old one. YES: components are interchangeable. NO: components are not interchangeable.

## TABELLA COLLEGAMENTO CODICE CALDAIA - ESPLOSO TABLEAU CONNECTION CODEX CHAUDIERE - VUE ECLATEE BOILERS CONNECTION BOARD - EXPLODED VIEW

BOILER CODE	BOILER DESCRIPTION	EXPLODED REF.
CODICE CALDAIA	DESCRIZIONE CALDAIA	RIF. ESPLOSO
CODIGO CALDERA	DESCRIPCION CALDERA	REF. EXPLOSIONADO
CODE CHAUDIÈRE	DESCRIPTION CHAUDIÈRE	RÉF. EXPLOSÉE
CSB456253693	LUNA3 COMFORT AIR 250Fi	Tab 356
CSB456253691/2	LUNA3 COMFORT AIR 250Fi	Tab 356
CSB456253690	LUNA3 COMFORT AIR 250Fi	Tab 316
CSB456313693	LUNA3 COMFORT AIR 310Fi	Tab 356
CSB456313691/2	LUNA3 COMFORT AIR 310Fi	Tab 356
CSB456313690	LUNA3 COMFORT AIR 310Fi	Tab 316
CSB453243580/1	LUNA3 COMFORT MAX 240i	Tab 318
CSB458253580/1	LUNA3 COMFORT MAX 250Fi	Tab 317
CSB458313580/1	LUNA3 COMFORT MAX 310Fi	Tab 317

# LUNA3 COMFORT MAX - AIR

15/01/2015

Pos	Code	Description code	CSB453243580/1 MAX 240i	AIR 250Fi	CSB456253690 AIR 250Fi	CSB456253691/2 AIR 250Fi	CSB45613690 AIR 310Fi	CSB45613691/2 AIR 310Fi	CSB458313580/1 MAX 250Fi	CSB458313580/1 MAX 310Fi	CSB458313580/1 AIR 250Fi	CSB45613693 AIR 310Fi	To serial number	From serial number	Intercha ngeable:
1	5683090	SUPPORT FRAME	•	•	•	•	•	•	•	•	•	•			
2	5116190	LEFT PANEL	•												
2	5681390	LEFT PANEL		•	•	•	•	•	•	•	•	•			
3	5116170	RIGHT PANEL	•												
3	5681380	RIGHT PANEL		•	•	•	•	•	•	•	•	•			
4	623680	FRONT. PAN.ASS.LUNA3 OPEN FLUE	•												
4	5115970	FRONTAL PANEL LUNA3		•	•	•	•	•	•	•	•	•			
5	5110290	BRACKET-UPPER SUPPORT	•	•	•	•	•	•	•	•	•	•			
6	5109640	BRACKET-LOWER SUPPORT		•	•	•	•				•	•			
6	5111710	BRACKET-LOWER-SUPPORT	•						•	•					
8	5408080	PRESSURE SWITCH PIPE L=270		•	•	•	•	•	•	•	•	•			
9	625400	RESTRICT.AIR ASS.80-60/43-S45		•	•	•	•	•	•	•	•	•			
10	5207060	FLUE ADAPTOR		•	•	•	•	•	•	•	•	•			
11	5407890	GASKET ADAPTOR		•	•	•	•	•	•	•	•	•			
12	5108690	PLATE BLANKING		•	•	•	•	•	•	•	•	•			
13	5407400	SUCTION CAP GASKET		•	•	•	•	•	•	•	•	•			
15	600530	JOINT ASSEMBLY		•	•	•	•	•	•	•	•	•			
17	5213750	CONVEYOR BEND LUNA3		•	•	•	•	•	•	•	•	•			
18	5407050	PRESSURE SENSING VENTURI		•	•				•		•				
18	5413850	PRESS.SENS.VENTURI SINGLE TAP					•	•		•		•			
21	5402050	WASHER-SEALING	•	•	•	•	•	•	•	•	•	•			
22	5653850	FAN - 80		•	•				•		•				
22	5655730	FAN - 105				•	•			•		•			
23	618470	FAN PRESS.SWITCH 1,2mBAR HONEY		•	•				•				C120	B441	
23	628150	FLUE PRESS.SWITCH 1,2mBAR HUBA		•	•				•				C144		
23	628610	PRESS.SWITCH ASS. 0,68mbar HONEYW.										•			
23	628610	PRESS.SWITCH ASS. 0,68mbar HONEYW.					•	•		•				C121	YES
23	628640	PRESS.SWITCH ASS.1.2mbar HONEYW.		•	•				•					C121	YES
23	628640	PRESS.SWITCH ASS.1.2mbar HONEYW.									•				
23	5663820	PRESSURE SWITCH 80 ASS. IND.					•	•		•			C120		
23	710789900	PRESSURE SWITCH ASSEMBLY HUBA					•	•		•		•	1448		
23	710790300	FLUE PRESS.SWITCH 1,2mBAR HUBA									•		1448		
23	710790300	FLUE PRESS.SWITCH 1,2mBAR HUBA		•	•				•				1448	C145	YES
23	721890300	FLUE PRESS.SWITCH 70-60Pa HUBA					•	•		•		•		1449	YES
23	721890800	FLUE PRES.SWITCH 95-115Pa HUBA		•	•				•		•			1449	YES
24	5407930	PIPE - VALVE COMPENSATION		•	•	•	•	•	•	•			B923		
24	5414320	PIPE-VALVE COMPENS.4,5x8 L=170									•	•			
24	5414320	PIPE-VALVE COMPENS.4,5x8 L=170		•	•	•	•	•	•	•				B924	YES
25	5681090	CONVEYOR ASSEMBLY LUNA3		•	•	•	•	•	•	•	•	•			
27	5680950	COMBUSTION CHAMBER ASS. 31KW					•	•		•		•			
27	5681180	COMBUSTION CHAMBER ASS. 24Kw		•	•				•		•				
27	5681700	COMBUST.CHAMBER ASSEMBLY ATM	•												
28	5213190	INSULATING PANEL	•	•	•	•	•	•	•	•	•	•			

# LUNA3 COMFORT MAX - AIR

15/01/2015

Pos	Code	Description code	CSB45243380/1 MAX 240i	CSB45233380/1 AIR 250i	CSB456253690 AIR 250i	CSB456253691/2 AIR 250i	CSB456313690 AIR 310i	CSB456313691/2 AIR 310i	CSB458253380/1 MAX 250i	CSB458253380/1 MAX 310i	CSB458313380/1 MAX 310i	CSB456253693 AIR 310i	To serial number	From serial number	Intercha ngeable:
29	5213290	INSULATION - REAR PANEL	•	•	•	•	•	•	•	•	•	•			
30	5213310	INSULATING PANEL	•												
30	5213340	INSULATING PANEL		•	•	•	•	•	•	•	•	•			
31	5108030	CONBUSTION CHAMBER FRONT PLATE	•												
31	5111840	PANEL-COMBUSTION CHAMBER 80		•	•				•			•			
31	5111850	PANEL-COMB CHAMBER-105					•	•		•		•			
32	620860	H2O/GAS EXCHANGER 24KW+CLIP	•	•	•				•			•			
32	620870	H2O/GAS EXCHANGER 31KW+CLIP					•	•		•		•			
33	5403130	O-RING 22 x 3	•	•	•	•	•	•	•	•			1311		
33	710963000	OR 21,5X3 EP70 TFL	•	•	•	•	•	•	•	•				1312	YES
33	710963000	OR 21,5X3 EP70 TFL									•	•			
34	5113650	PRIMARY EXCHANGER FIXING CLIP	•	•	•	•	•	•	•	•	•	•			
35	5625560	VESSEL EXPANSION - 8L		•	•								C014		
35	5625570	VESSEL EXPANSION - 8L									•				
35	5625570	VESSEL EXPANSION - 8L		•	•									C015	YES
35	5671070	EXPANSION VESSEL	•						•	•					
35	9951820	EXPANSION VESSEL 10 L.					•	•				•			
36	5653290	PIPE - EXPANSION VESSEL		•	•	•	•					•			
37	5653710	PANEL COMBUSTION BOX FRONT 80		•	•				•			•			
37	5655750	PANEL-COMBUSTION BOX					•	•		•		•			
38	5401610	VIEWING WINDOW GASKET		•	•	•	•	•	•	•	•	•			
39	5203930	VIEWING WINDOW		•	•	•	•	•	•	•	•	•			
40	5115590	SURROUND-SIGHT GLASS		•	•	•	•	•	•	•	•	•			
41	5653300	BURNER ASSEMBLY (15 ELEMENTS)	•	•	•	•	•	•	•	•	•	•			
42	5604090	BURNER ELEMENT	•	•	•	•	•	•	•	•	•	•			
43	606140	MANIFOLD - BURNER	•	•	•				•			•			
43	621070	RAMP GAS ASS. 15 HOLE D0.74	•	•	•				•			•			
43	5680970	GAS RAMP WITH INJECT. (D.1,28)					•	•		•		•			
43	5687770	GAS RAMP ASSEMB 15 HOLE D.0.77					•	•		•		•			
44	601520	INJECTOR KIT D. 0,74	•	•	•				•			•			
44	608430	TRANSFORM. KIT N.G. (15x1,28)					•	•		•		•			
44	608440	TRANSFORM. KIT N.G. (18x1,18)	•	•	•				•			•			
44	608450	TRANSFORM.KIT LPG(15x 0,77)					•	•		•		•			
45	5407940	GASKET-BURNER MANIFOLD	•	•	•	•	•	•	•	•	•	•			
46	5657180	ADAPTOR-MANIFOLD	•	•	•	•	•	•	•	•	•	•			
47	5407810	GASKET-MANIFOLD ADAPTOR		•	•	•	•	•	•	•	•	•			
48	5116650	BURNER PROTECTION	•												
49	5207070	FLUE SAMPLE PLUG		•	•	•	•	•	•	•	•	•			
59	8419050	LEAD - IGNITION ELECTRODE	•	•	•	•	•	•	•	•	•	•			
61	5404920	INSULATION BOOT-ELECTRODES	•												
61	5407830	INSULATION BOOT - ELECTRODE		•	•	•	•	•	•	•	•	•			
62	5409570	SEALED CHAMBER HOSE ADAPTER		•	•	•	•	•	•	•	•	•			
63	8422570	ELECTRODE - IGNITION	•	•	•	•	•	•	•	•	•	•			
70	5688900	PIPE ASSEMBLY PUMP/EXCHANGER	•	•	•	•	•	•	•	•	•	•			

# LUNA3 COMFORT MAX - AIR

15/01/2015

Pos	Code	Description code	CSB45243380/1 MAX 240l	AIR 250l	CSB456253690 AIR 250l	CSB456253691/2 AIR 250l	CSB456313690 AIR 310l	CSB456313691/2 AIR 310l	MAX 250l	CSB458253580/1 MAX 250l	CSB458313380/1 MAX 310l	CSB458313380/1 AIR 250l	CSB456253693 AIR 310l	CSB456313693 AIR 310l	To serial number	From serial number	Intercha ngeable:
70	711192200	PUMP/EXCHANGER PIPE ASSEMBLY															
72	5659550	PUMP UPS 15-60 AO & CONNECTOR															
72	5661200	PUMP UP 15-50/CONNECTOR															
72	5687280	PUMP UP 15-50 AO 2 SPEED															
72	5687510	PUMP UP 15-60 AO C/CON 3SPEED															
73	607290	AUTOMATIC AIR VENT															
74	5406360	O-RING 14X1,78 EP															
75	5404670	GROMMET - PIPE ASSEMBLY															
76	5686670	DHW PLATE EXCHANGER 12 PLATES															
76	5686680	DHW PLATE EXCHANGER 14 PLATE															
76	5689930	EXCHANGER 20 PLATE TO PLATE															
76	711612800	DHW PLATE EXCHANGER 12 PLATES															
76	711613000	DHW PLATE EXCHANGER 14 PLATES															
77	5404520	DHW PLATE EXCHANGER GASKET															
77	711613500	DHW PLATE EXCHANGER OR															
80	5680920	GROUP -15.0553-															
80	5692900	ES-RR ASS. C/REDUCT.8L															
80	5692910	ES-RR ASS. C/REDUCT.12L															
80	5693860	HYDR.INLET GR.WITH BYPASS															
80	711607500	HYDRAULIC INLET GROUP															
80	711608300	HYDRAULIC INLET GROUP															
81	620340	FILTER-TRASDUC GROUP -100078-															
81	621090	FILTER TRANSD.RIDUCT.8L ASSEMB															
81	711633500	FILTER ASS.WITH RED.10L-100291															
87	631680	PUMP CONNECTING ELEMENT/OR														1302	YES
87	5210710	PUMP CONNECTING ELEMENT													1301		
87	711652300	PUMP CONNECTING ELEMENT/OR															
90	620890	FILLING GR.WITH TURBINE 120074															
91	5652030	DRAINING TAP															
92	9951170	SAFETY VALVE 3 BAR															
92	710109400	HYDRAULIC SAFETY VALVE 3 BAR															
98	5212890	BY PASS PIPE ASSY															
98	5213880	BY-PASS PIPE CUBE															
99	8380850	FIXING CLIP															
102	5680940	GROUP LUNA3 -15.0552-															
102	5688590	3 WAY VALVE ASSEMBLY															
102	5696200	MR-US ASS.WITHOUT BYPASS150734															
102	711606100	3 WAY VALVE ASSEMBLY															
113	605740	BY PASS ASSEMBLY															
113	617100	BY-PASS GR.															
114	5403820	O-RING 26,64 X 2,62															
119	605760	HYDRAULIC VENTURI ASSEMBLY															
120	600750	SPACER ASSEMBLY															
120	626710	DHW PADDLE GROUP -10.0355-													B846		



# LUNA3 COMFORT MAX - AIR

15/01/2015

Pos	Code	Description code	CSB45243380/1 MAX 240i	CSB456313690 AIR 310Fi	CSB456253690 AIR 250Fi	CSB456313691/2 AIR 250Fi	CSB456253691/2 AIR 250Fi	CSB456313690 AIR 310Fi	CSB456253690 AIR 250Fi	CSB456313691/2 AIR 250Fi	CSB456253691/2 AIR 250Fi	CSB456313690 AIR 310Fi	CSB456253690 AIR 250Fi	CSB456313691/2 AIR 250Fi	CSB456253691/2 AIR 250Fi	To serial number	From serial number	Intercha ngeable:
200	5701230	CONNECTION ASSEMBLY PRIME HT	•														B943	
200	5701230	CONNECTION ASSEMBLY PRIME HT				•	•	•	•								B929	
201	5625950	CONNECTION HEATING ASSEMBLY		•				•										
201	5625950	CONNECTION HEATING ASSEMBLY				•	•	•								B928		
201	5625950	CONNECTION HEATING ASSEMBLY	•													B942		
203	5628020	CONNECTING PIPE		•				•										
203	5628020	CONNECTING PIPE								•	•					B928		
203	5628020	CONNECTING PIPE	•													B942		
204	5625980	CONNECT.SANITARY AND INLET TAP		•				•										
204	5625980	CONNECT.SANITARY AND INLET TAP				•		•	•	•						B928		
204	5625980	CONNECT.SANITARY AND INLET TAP	•													B942		
209	5627620	CONNECTION GAS INLET TAP		•				•										
209	5627620	CONNECTION GAS INLET TAP				•		•	•	•						B928		
209	5627620	CONNECTION GAS INLET TAP	•													B942		
210	9950830	GAS TAP	•	•	•	•	•	•	•	•	•	•	•	•	•			
212	5408330	BICONIC GASKET	•													B942		
212	5408330	BICONIC GASKET		•				•										
212	5408330	BICONIC GASKET							•	•						B928		
232	5689820	PCB RELAY LUNA3		•	•	•	•					•	•					
241	5669470	AIR CHAMBER ASSEMBLY	•															
242	606930	FLUE SAFETY THERMOSTAT 60C	•															
259	5681120	BRAND BAXI LUNA3	•	•	•	•	•	•	•	•	•	•	•	•	•			
280	5207730	GASKET 14,2X18X1,5	•	•	•	•	•	•	•	•	•	•	•	•	•			
286	8240530	NUT M5	•															
290	5665600	MODUL. ASSEMBLY VK4105M	•	•	•	•	•	•	•	•	•	•	•	•	•			
314	8418870	LEAD - SENSING ELECTRODE	•	•	•	•	•	•	•	•	•	•	•	•	•			
336	8380680	CLIP-RETAINING	•	•	•	•	•	•	•	•	•	•	•	•	•			
337	5647340	MOTOR-3 WAY VALVE	•	•				•	•	•						B952		
337	5694580	3 WAY VALVE MOTOR	•	•				•	•	•							B953	YES
337	5694580	3 WAY VALVE MOTOR			•			•				•	•					
340	9951690	PRESSURE SWITCH	•	•	•	•	•	•	•	•	•	•	•	•	•			
347	5682690	REMOTE CONTROL ASSEMBLY	•						•	•								
347	5693700	WIRELESS REMOTE CONTROL LUNA3		•	•	•	•	•						•	•			
421	5408270	O-RING 11,91 X 2,62 NBR	•	•				•	•									
425	5412270	GASKET FAN HT		•	•	•	•	•	•	•	•	•	•	•	•			
467	9950310	NUT G 3/4	•													B942		
467	9950310	NUT G 3/4							•	•						B928		
467	9950310	NUT G 3/4		•				•										
468	5627970	CONNECTING ELEMENT G 3/4		•				•										
468	5627970	CONNECTING ELEMENT G 3/4							•	•						B928		
468	5627970	CONNECTING ELEMENT G 3/4	•													B942		
471	5625960	DHW OUTLET		•				•										
471	5625960	DHW OUTLET				•		•	•	•						B928		
471	5625960	DHW OUTLET	•													B942		





# LUNA3 COMFORT MAX - AIR

Pos	Code	Description code	CSB45243380/1 MAX 240i	CSB45253690 AIR 250Fi	CSB45253691/2 AIR 250Fi	CSB456313690 AIR 310Fi	CSB456313691/2 AIR 310Fi	CSB458253580/1 MAX 250Fi	CSB458253580/1 MAX 310Fi	CSB458313380/1 AIR 250Fi	CSB458313380/1 AIR 310Fi	To serial number	From serial number	Intercha ngeable:
715	5402700	ORING 15,60X1,78	•	•		•		•	•					
732	620210	SPRING ASS.	•	•		•		•	•					
739	5116660	BURNER PROTECTION PROFILE	•											
755	5693630	WIRELESS RECEIVER LUNA3		•	•	•	•			•	•			
808	721311400	O-RING 18X2								•	•			
809	711615000	SPRING								•	•			
999	8414540	CABLE ROOM TH	•	•	•	•	•	•	•	•	•			
999	8414620	POWER CABLE	•	•	•	•	•	•	•	•	•			
999	8419080	CABLE - EARTH	•	•	•	•	•	•	•	•	•			
999	8512270	WIRING		•	•	•	•	•	•	•	•			
999	8512290	CH NTC/AIR PRESS CABLE		•	•	•	•	•	•	•	•			
999	8512300	DHW NTC/MOD/H20 PRES	•	•	•	•	•	•	•	•	•			
999	8512310	PCB POWER CABLE	•	•	•	•	•	•	•	•	•			
999	8512330	POWER SUPPLY WIRING	•											
999	8512350	CH NTC/TH LIM/TH FLUE CABLE	•											
999	8512380	REMOTE CONTROL CONN. CABLE	•	•	•	•	•	•	•	•	•			
999	8512790	RELAY PCB CABLE		•	•	•	•			•	•			







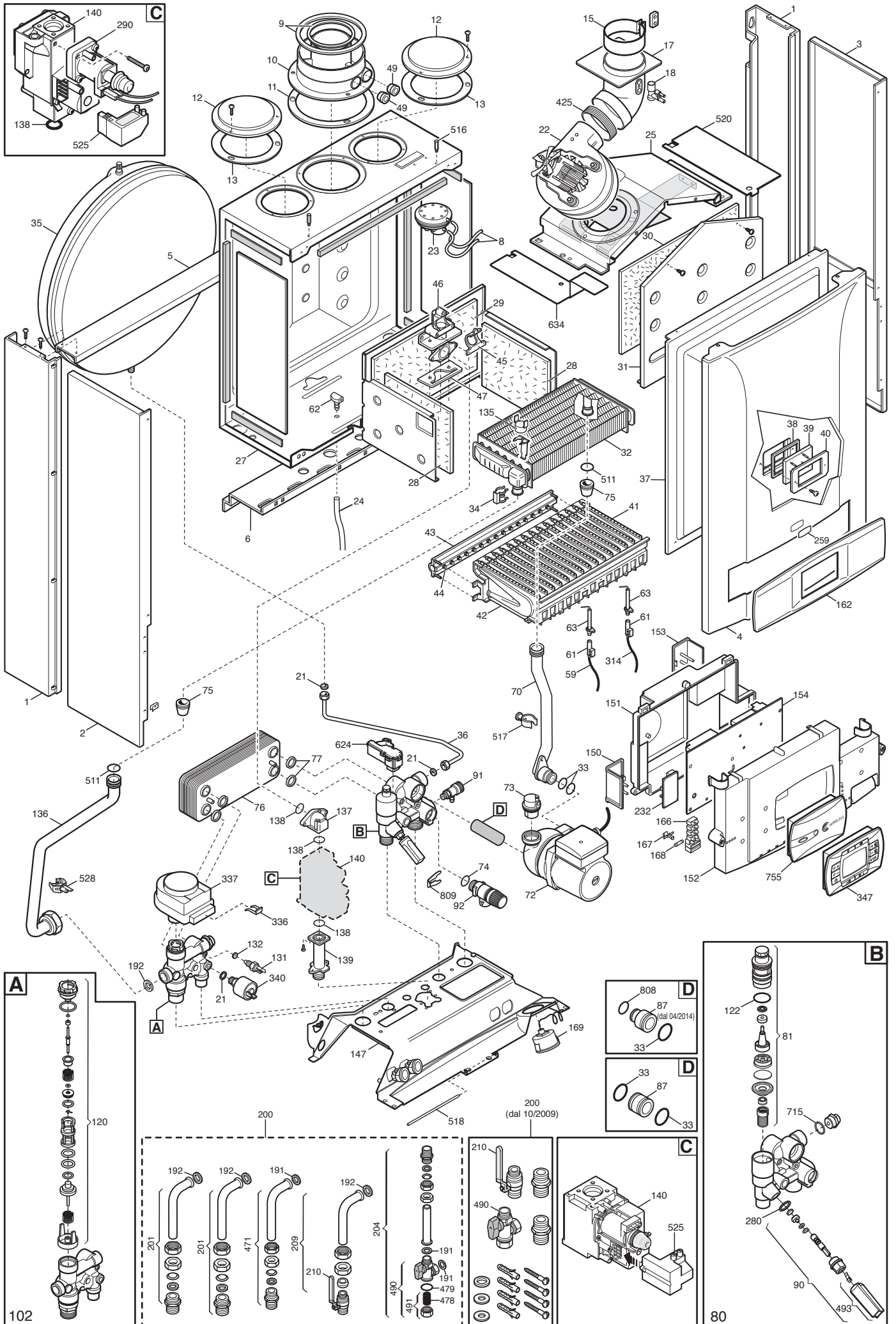

**BAXI**

**BAXI S.p.A.**  
**Via Trozzetti, 20**  
**36061 BASSANO DEL GRAPPA (VI)**  
**ITALY**  
**Tel. +390424517111**  
**Telefax +390424517379**  
**E-mail. [service@baxi.it](mailto:service@baxi.it)**