

**NOTE**  
 - L'interno del tubo deve essere privo di sporco, trucioli, residui di lavorazione, ecc..  
 - Il particolare deve essere esente da bave e screpolature  
 - Pressione di collaudo: 4.5 bar  
 - Le flange devono essere saldati elettricamente  
 - Finitura: zincata

REVISION	MODIFICATION	ENGINEER	REFERS TO	DATE
<b>BAXI S.p.A.</b>		RELEASE STATUS: <b>Production</b>	ITEM NUMBER: <b>7106690.01</b>	REVISION: <b>1 of 1</b>
A MEMBER OF BAXI GROUP		ENGINEER: <b>Ceccato</b>	DATE: <b>03-Mar-11</b>	SHEET No. <b>1 of 1</b>
© 2009 BAXI S.p.A. - COLLETTORE MANDATA SEP.DN80				
UNITS   SCALE   MATERIAL SPECIFICATION   QUALITY SIGNIFICANCE				
mm   1:1   Gray   [C]=CRITICAL [I]=IMPORTANT				
TOLERANCE TO EN 22768 - mk UNLESS OTHERWISE SPECIFIED				
FIRST ANGLE PROJECTION				
ITEM CATEGORY (1, 2 OR 3) <b>3</b> <b>A1</b>				

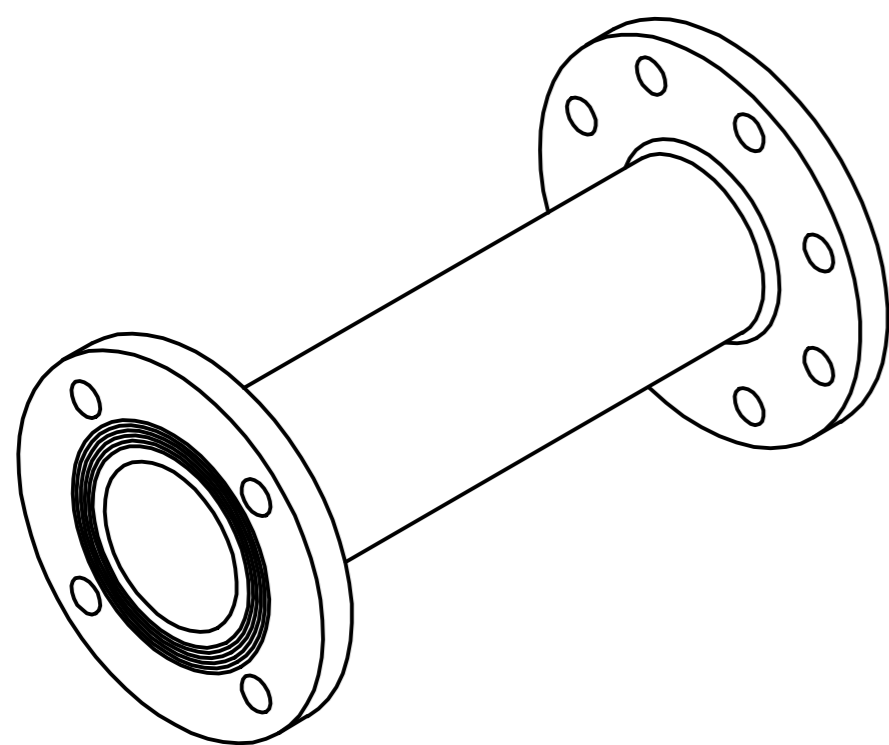
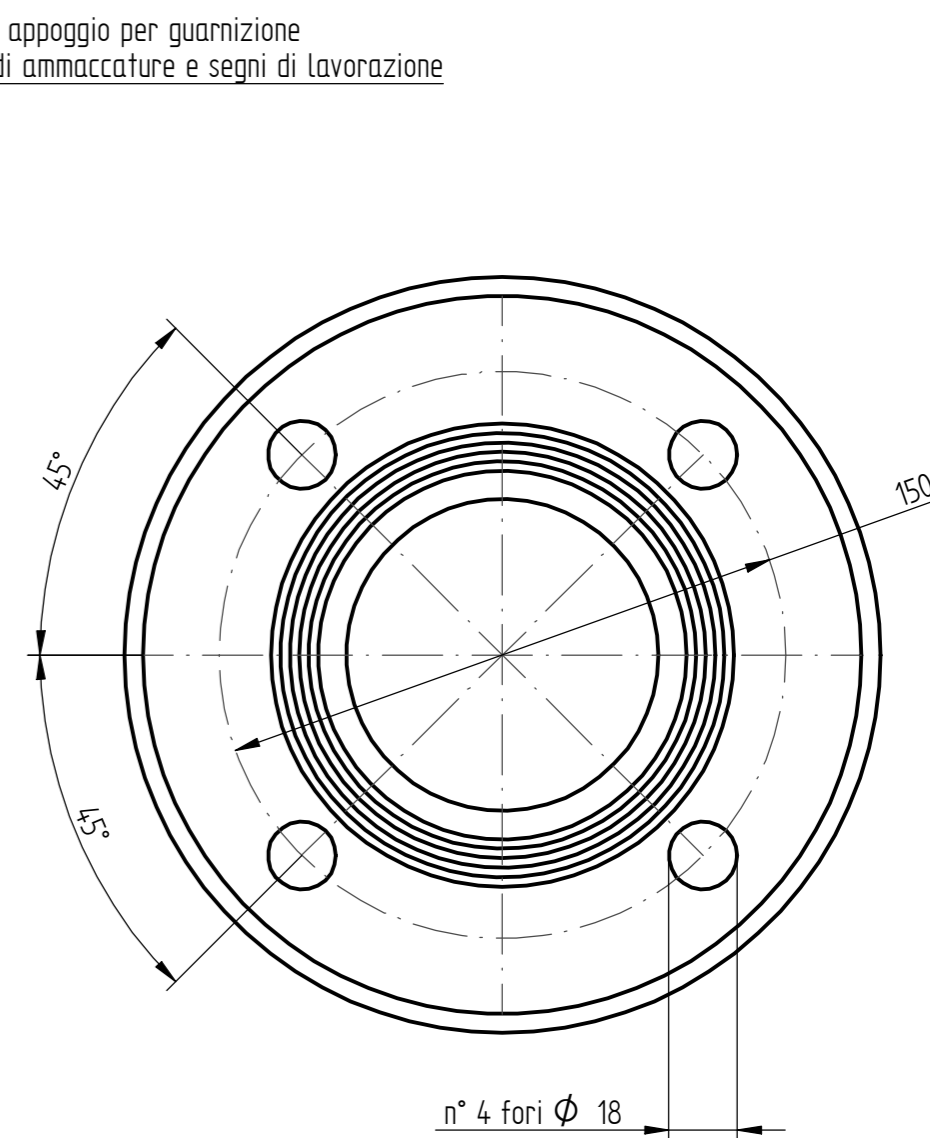
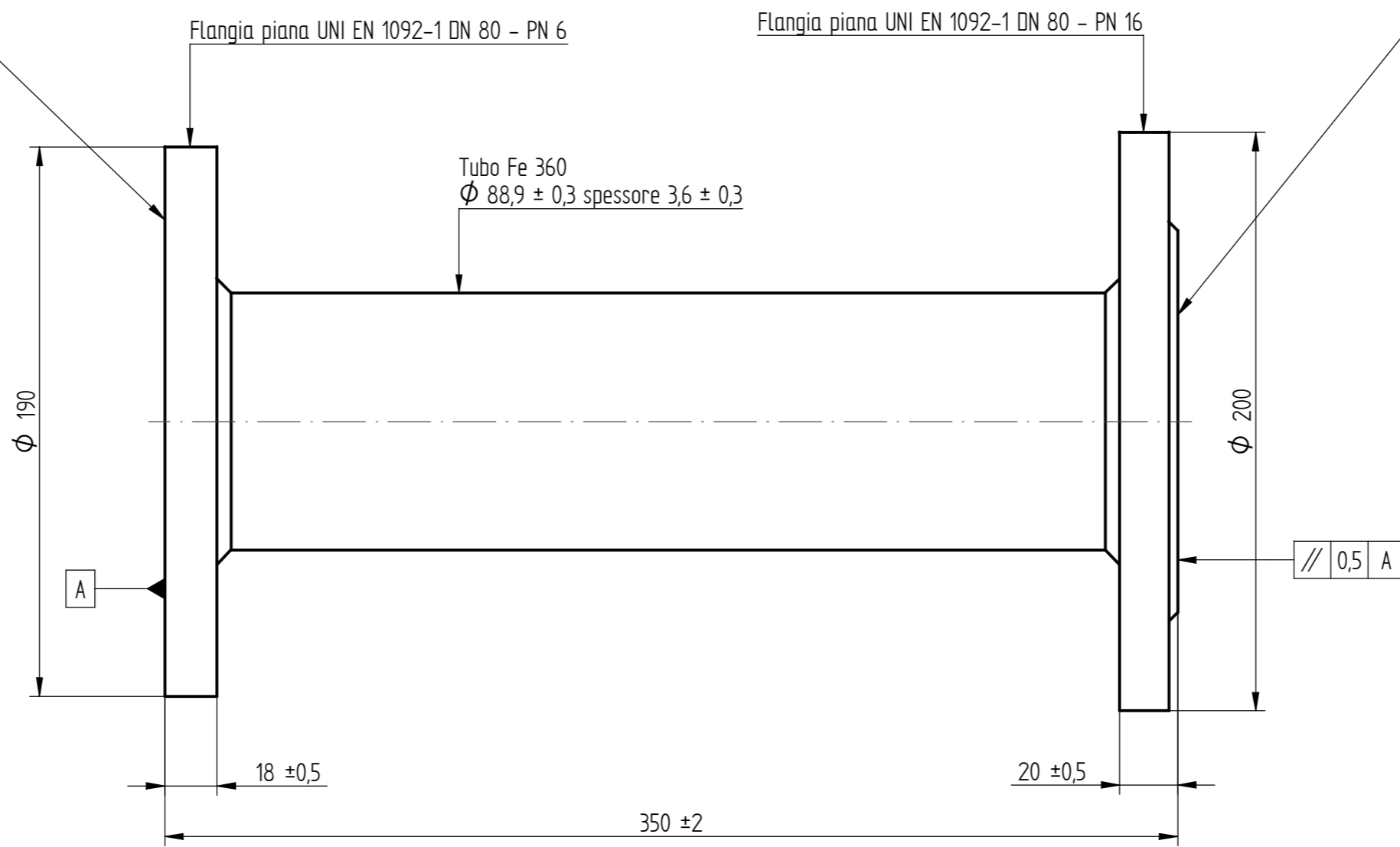
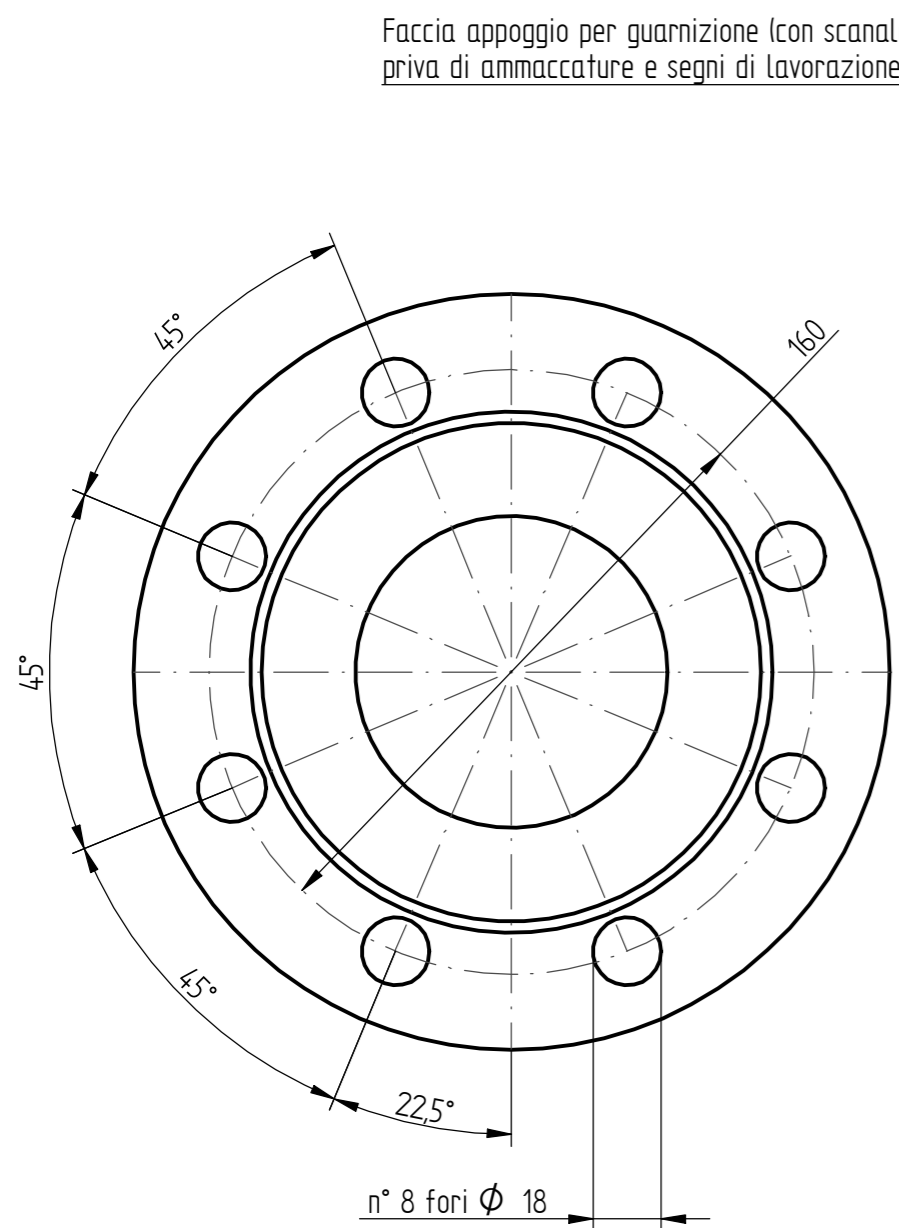

**NOTE**

- L'interno del tubo deve essere privo di sporco, trucioli, residui di lavorazione, ecc..
- Il particolare deve essere esente da bave e screpolature
- Pressione di collaudo: 4,5 bar
- Le flange devono essere saldate elettricamente
- Finitura: zincata

REVISION	MODIFICATION	ENGINEER	REFERS TO	DATE																																							
<b>BAXI S.p.A.</b>		RELEASE STATUS: <b>Production</b>	ITEM NUMBER: <b>7104778.01</b>	REVISION:																																							
A MEMBER OF BAXI GROUP		ENGINEER: <b>Ceccato</b>	DATE: <b>11-Oct-10</b>	SHEET No. <b>1 of 1</b>																																							
© 2009	TITLE: <b>COLLETTORE RITORNO SEP. DN80</b>																																										
UNITS: mm	SCALE: 1:2	MATERIAL SPECIFICATION:																																									
FIRST ANGLE PROJECTION	TOLERANCE TO EN 22768 - mK UNLESS OTHERWISE SPECIFIED	<table border="1"> <tr> <th>CLASS m</th> <th>0.3</th> <th>0.6</th> <th>1.0</th> <th>1.6</th> <th>2.5</th> <th>4.0</th> <th>6.3</th> </tr> <tr> <td>LINEAR</td> <td>±0.1</td> <td>±0.1</td> <td>±0.2</td> <td>±0.3</td> <td>±0.5</td> <td>±0.8</td> <td>±1.0</td> </tr> <tr> <td>RADI &amp; CHAMFERS</td> <td>±0.4</td> <td>±1</td> <td colspan="5">±1</td> </tr> <tr> <th>CLASS m</th> <th>0.05-0.10</th> <th>0.10-0.20</th> <th>0.20-0.50</th> <th>0.50-1.00</th> <th>1.00-4.00</th> <th>4.00+</th> <td></td> </tr> <tr> <td>ANGULAR</td> <td>±1'</td> <td>±1'30"</td> <td>±1'30"</td> <td>±1'10"</td> <td>±1'10"</td> <td>±1'15"</td> <td></td> </tr> </table>	CLASS m	0.3	0.6	1.0	1.6	2.5	4.0	6.3	LINEAR	±0.1	±0.1	±0.2	±0.3	±0.5	±0.8	±1.0	RADI & CHAMFERS	±0.4	±1	±1					CLASS m	0.05-0.10	0.10-0.20	0.20-0.50	0.50-1.00	1.00-4.00	4.00+		ANGULAR	±1'	±1'30"	±1'30"	±1'10"	±1'10"	±1'15"		QUALITY SIGNIFICANCE: [C]=CRITICAL [I]=IMPORTANT
CLASS m	0.3	0.6	1.0	1.6	2.5	4.0	6.3																																				
LINEAR	±0.1	±0.1	±0.2	±0.3	±0.5	±0.8	±1.0																																				
RADI & CHAMFERS	±0.4	±1	±1																																								
CLASS m	0.05-0.10	0.10-0.20	0.20-0.50	0.50-1.00	1.00-4.00	4.00+																																					
ANGULAR	±1'	±1'30"	±1'30"	±1'10"	±1'10"	±1'15"																																					
			ITEM CATEGORY (1, 2 OR 3)	<b>2</b>																																							
				<b>A2</b>																																							