

**BAXI**



# **LUNA3 SILVER SPACE**

## **SPARE PARTS CATALOGUE**

**- January 2015 -**



## HOW TO READ THE SPARE PARTS CATALOGUE

In the spare part catalogue, after the exploded diagrams, there are the components lists of the boilers; this is the meaning of the different columns:

Pos. Identification number of the component in the exploded diagram of the boiler.

Description Short description of the component.

Code BAXI S.p.A. code of the component.

Tab. XX XX is the exploded diagram number of the boiler taken into consideration.

From serial number Date (year and week) identifying the beginning of production of a component (taken from the serial number of the boiler).  
e.g. 1201: year 2012 (1 identifies the decade 2010-2019; 2 identifies the year) – 01th week.  
If the box is empty, the component is in use from the beginning of production of the boiler.

To serial number Date (year and week) identifying the end of production of a component (taken from the serial number of the boiler).  
e.g. 1225: year 2012 (1 identifies the decade 2010-2019; 2 identifies the year) – 25th week.  
If the box is empty, the component is still in use.

Interchangeable It identifies the interchangeability between the new component and the old one.  
YES: components are interchangeable.  
NO: components are not interchangeable.

## TABELLA COLLEGAMENTO CODICE CALDAIA - ESPLOSO TABLEAU CONNECTION CODEX CHAUDIERE - VUE ECLATEE BOILERS CONNECTION BOARD - EXPLODED VIEW

<b>BOILER CODE</b>	<b>BOILER DESCRIPTION</b>	<b>EXPLODED REF.</b>
<b>CODICE CALDAIA</b>	<b>DESCRIZIONE CALDAIA</b>	<b>RIF. ESPLOSO</b>
<b>CODIGO CALDERA</b>	<b>DESCRIPCION CALDERA</b>	<b>REF. EXPLOSIONADO</b>
<b>CODE CHAUDIÈRE</b>	<b>DESCRIPTION CHAUDIÈRE</b>	<b>RÉF. EXPLOSÉE</b>
CSB456253671	LUNA3 SILVER SPACE 250 FI	Tab 517
CSB456253672	LUNA3 SILVER SPACE 250FI	Tab 517
CSB456313671	LUNA3 SILVER SPACE 310 FI	Tab 517
CSB456313672	LUNA3 SILVER SPACE 310FI	Tab 517

# SILVER SPACE

Pos	Code	Description code					To serial number	From serial number	Intercha ngeable:
			CSB456313672 250 EI	CSB456313671 310 EI	CSB456253672 250 EI	CSB456313672 310 EI			
2	5692230	LEFT SIDE PANEL	•	•	•	•			
3	5692220	RIGHT SIDE PANEL	•	•	•	•			
4	5693660	FRONT.PAN.ASS.LUNA3 SILV.SPACE	•	•	•	•			
8	5408080	PRESSURE SWITCH PIPE L=270	•	•	•	•			
9	625380	REDUCT.GROUP. LUNA3 IN/SPACE		•		•			
9	625440	REDUCT.GR.LUNA3 COMF.IN/SPACE	•		•				
10	5207060	FLUE ADAPTOR	•	•	•	•			
11	5407890	GASKET ADAPTOR	•	•	•	•			
12	5113310	SUCTION CAP	•	•	•	•			
13	5407400	SUCTION CAP GASKET	•	•	•	•			
14	5413590	TOP PANEL LUNA3 SILV. SPACE	•		•				
14	5413600	TOP PANEL LUNA3 SIL. SP.310		•		•			
15	5621890	CLAMP - FLUE DUCT	•	•	•	•			
17	5213750	CONVEYOR BEND LUNA3	•	•	•	•			
18	5407050	PRESSURE SENSING VENTURI	•		•				
18	5413850	PRESS.SENS.VENTURI SINGLE TAP		•		•			
21	5402050	WASHER-SEALING	•	•	•	•			
22	5653850	FAN - 80	•		•				
22	5655730	FAN - 105		•		•			
23	628610	PRESS.SWITCH ASS. 0,68mbar HONEYW.		•		•			
23	628640	PRESS.SWITCH ASS.1.2mbar HONEYW.	•		•				
23	710789800	FLUE PRES. SWITCH 70-60Pa HUBA		•		•	1448		
23	710790200	FLUE PRESS.SWITCH 115-95Pa HUBA	•		•		1448		
23	721890200	FLUE PRES. SWITCH 70-60Pa HUBA		•		•		1449	YES
23	721890700	FLUE PRES. SWIT. 115-95Pa HUBA	•		•			1449	YES
24	5407930	PIPE - VALVE COMPENSATION	•	•	•	•			
25	5681090	CONVEYOR ASSEMBLY LUNA3	•	•	•	•			
27	5689560	COMB.CH.ASS.LUNA3 IN FF 24kW	•		•				
27	5689920	COMB.CH. ASS.LUNA3 IN FF 31kW		•		•			
28	5213190	INSULATING PANEL	•	•	•	•			
29	5213290	INSULATION - REAR PANEL	•	•	•	•			
30	5213340	INSULATING PANEL	•	•	•	•			
31	5111840	PANEL-COMBUSTION CHAMBER 80	•		•				
31	5111850	PANEL-COMB CHAMBER-105		•		•			
32	620860	H2O/GAS EXCHANGER 24KW+CLIP	•		•				
32	620870	H2O/GAS EXCHANGER 31KW+CLIP		•		•			
33	710963000	OR 21,5X3 EP70 TFL	•	•	•	•			
34	5113650	PRIMARY EXCHANGER FIXING CLIP	•	•	•	•			
35	9952290	EXPANSION VESSEL 7,5L	•	•	•	•			

# SILVER SPACE

Pos	Code	Description code	CSB456233671	CSB456313671	CSB456233672	CSB456313672	To serial number	From serial number	Intercha ngeable:
			250 FI	310 FI	250 FI	310 FI			
36	5660380	EXPANSION VESSEL PIP	•	•	•	•			
37	5666030	FRONTAL PANEL COMB CHAMBER	•		•				
37	5666040	FRONT.PANEL COMB.CHAMB.IN 31kW		•		•			
38	5401610	VIEWING WINDOW GASKET	•	•	•	•			
39	5203930	VIEWING WINDOW	•	•	•	•			
40	5115590	SURROUND-SIGHT GLASS	•	•	•	•			
41	5653300	BURNER ASSEMBLY (15 ELEMENTS)	•	•	•	•			
42	5604090	BURNER ELEMENT	•	•	•	•			
43	606140	MANIFOLD - BURNER	•		•				
43	621070	RAMP GAS ASS. 15 HOLE D0.74	•		•				
43	5680970	GAS RAMP WITH INJECT. (D.1,28)		•		•			
43	5687770	GAS RAMP ASSEMB 15 HOLE D.0.77		•		•			
44	601520	INJECTOR KIT D. 0,74	•		•				
44	608430	TRANSFORM. KIT N.G. (15x1,28)		•		•			
44	608440	TRANSFORM. KIT N.G. (18x1,18)	•		•				
44	608450	TRANSFORM.KIT LPG(15x 0,77)		•		•			
45	5407940	GASKET-BURNER MANIFOLD	•	•	•	•			
46	5657180	ADAPTOR-MANIFOLD	•	•	•	•			
47	5407810	GASKET-MANIFOLD ADAPTOR	•	•	•	•			
49	5207070	FLUE SAMPLE PLUG	•	•	•	•			
59	8419050	LEAD - IGNITION ELECTRODE	•	•	•	•			
61	5407830	INSULATION BOOT - ELECTRODE	•	•	•	•			
62	5409570	SEALED CHAMBER HOSE ADAPTER	•	•	•	•			
63	8422570	ELECTRODE - IGNITION	•	•	•	•			
70	5689790	PIPE PUMP/EXCH.LUNA3 IN FF	•	•	•	•			
72	5659550	PUMP UPS 15-60 AO & CONNECTOR		•		•			
72	5661200	PUMP UP 15-50/CONNECTOR	•		•				
73	607290	AUTOMATIC AIR VENT	•	•	•	•			
74	5406360	O-RING 14X1,78 EP	•	•	•	•			
75	5404670	GROMMET - PIPE ASSEMBLY	•	•	•	•			
76	5686670	DHW PLATE EXCHANGER 12 PLATES	•						
76	5686680	DHW PLATE EXCHANGER 14 PLATE		•					
76	711612800	DHW PLATE EXCHANGER 12 PLATES			•				
76	711613000	DHW PLATE EXCHANGER 14 PLATES				•			
77	5404520	DHW PLATE EXCHANGER GASKET	•	•					
77	711613500	DHW PLATE EXCHANGER OR			•	•			
80	5696450	HYDR.INLET GR.WITHOUT BYPASS	•	•					
80	711607200	HYDR.INLET GR.WITHOUT BYPASS			•	•			
81	620340	FILTER-TRASDUC GROUP -100078-	•	•	•	•			
87	631680	PUMP CONNECTING ELEMENT/OR	•	•					
87	711652300	PUMP CONNECTING ELEMENT/OR			•	•			
90	620890	FILLING GR.WITH TURBINE 120074	•	•	•	•			





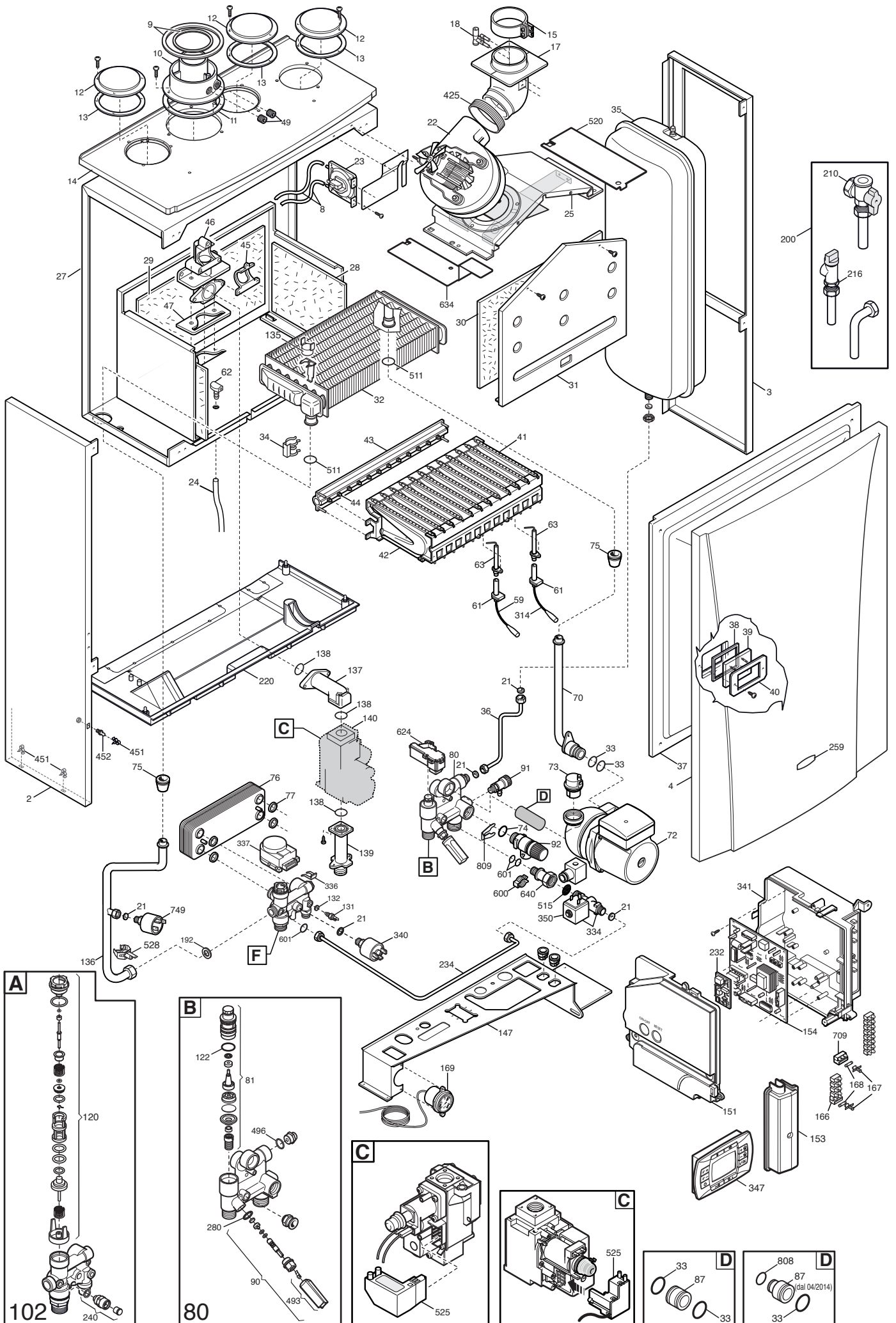



**BAXI**

**BAXI S.p.A.**  
**Via Trozzetti, 20**  
**36061 BASSANO DEL GRAPPA (VI)**  
**ITALY**  
**Tel. +390424517111**  
**Telefax +390424517379**  
**E-mail. [service@baxi.it](mailto:service@baxi.it)**